

Figure 1.3: MAP OF THE PLACES FROM WHICH THEOROI CAME TO THE SAMOTHRACIAN MYSTERIES.

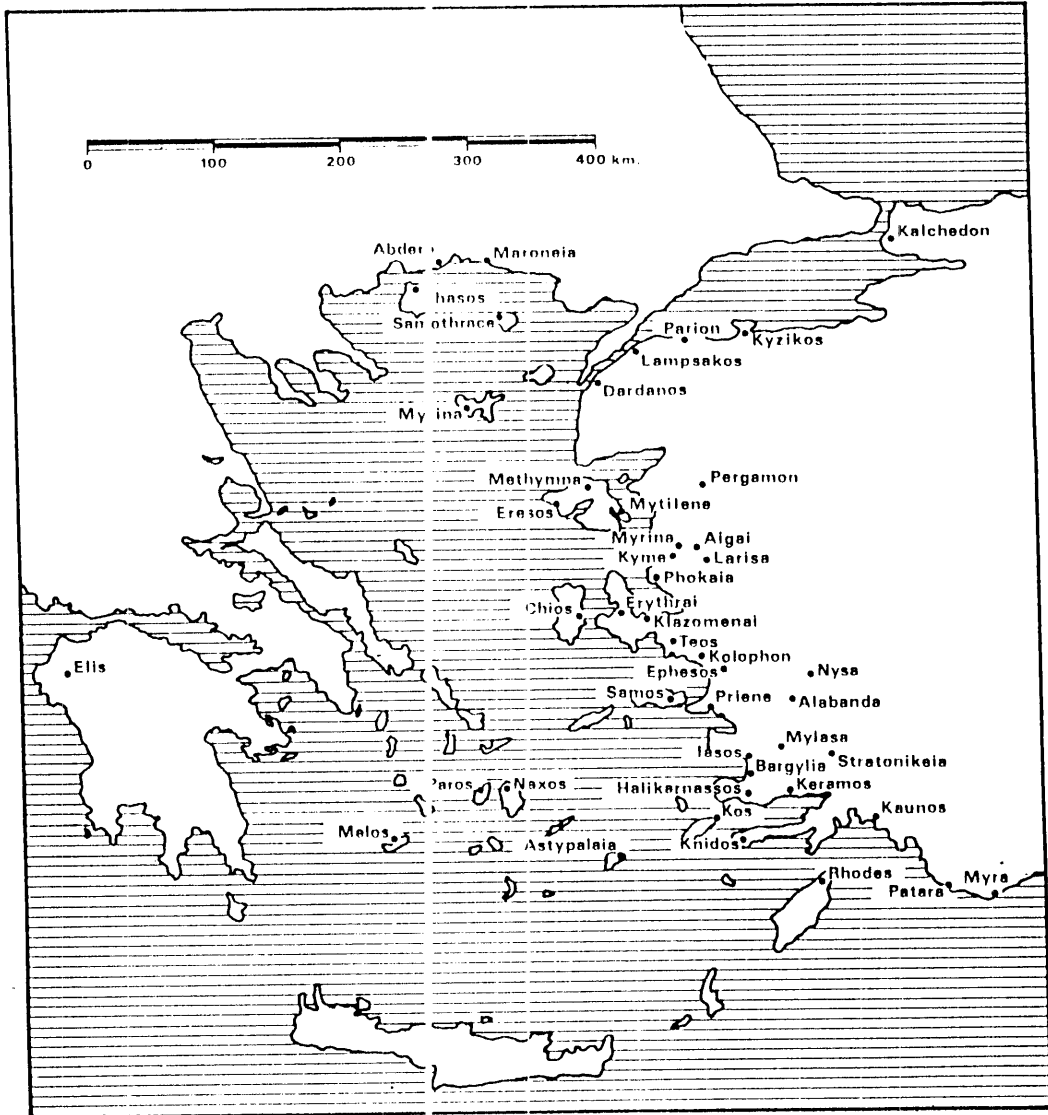


Figure 1.4: MAP OF PLACES FROM WHICH MYSTAI CAME FOR THE SAMOTHRACIAN MYSTERIES.

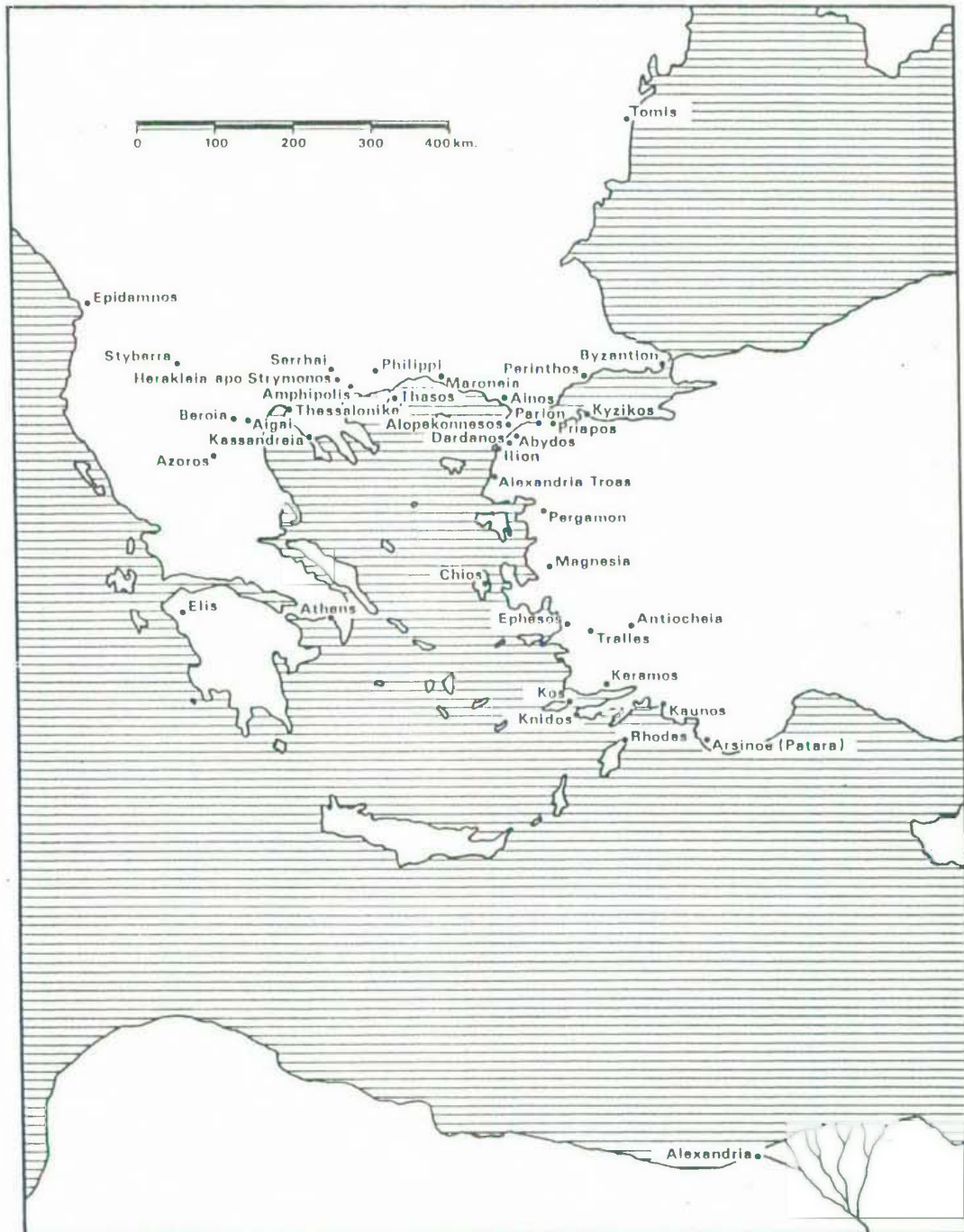


Figure 1.5: A HERALD'S *KERYKEION*, SYRACUSE, WITH DEDICATORY (?)
INSCRIPTION: ΣΥΡΑΚΟΣΙΟΝ ΔΑΜΟΣΙΟΝ (see also *FRONTISPIECE*).

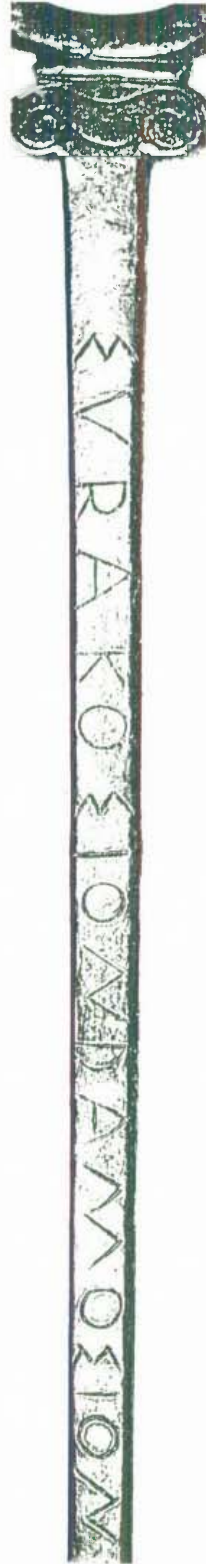


Figure 2.1: THE ROUTE FROM ELIS TO OLYMPIA TAKEN BY THE COMPETITORS.

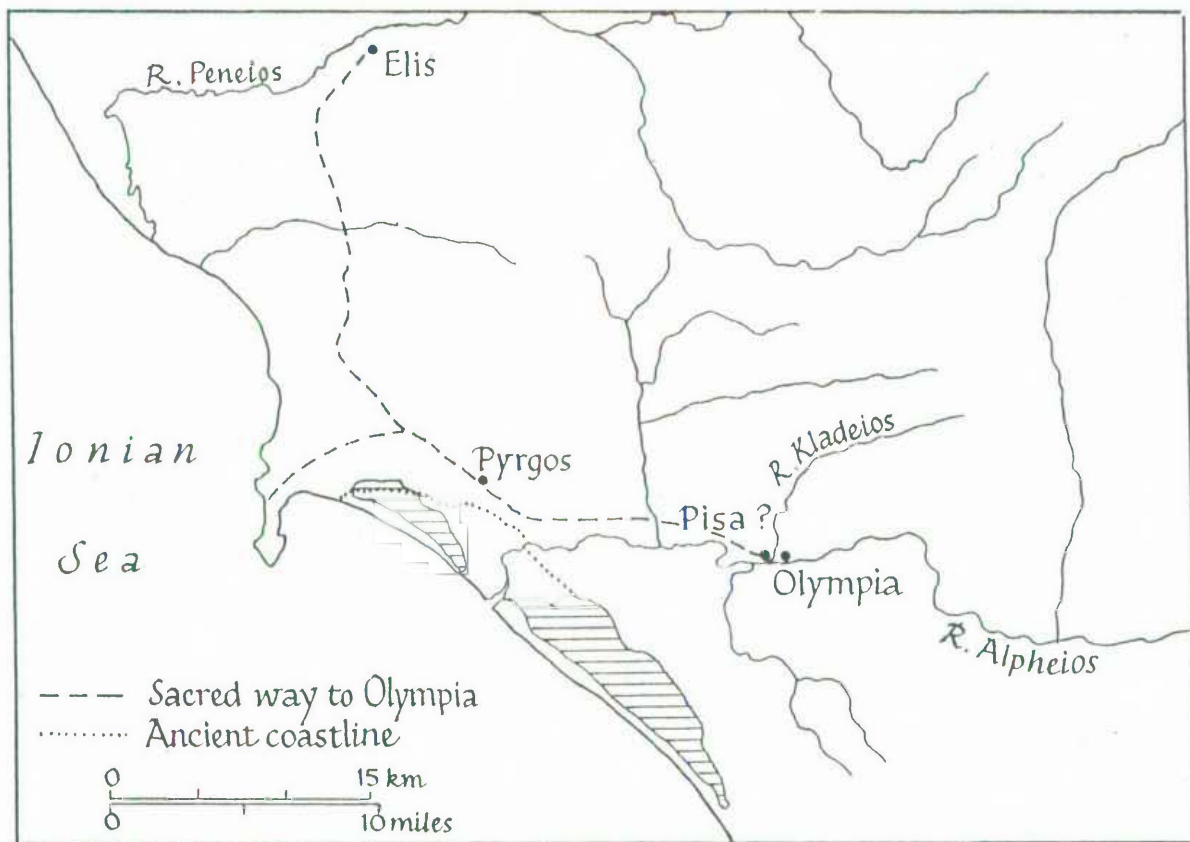


Figure 2.2: MAP OF THE PROCESSIONAL ROUTE FROM ATHENS TO ELEUSIS.

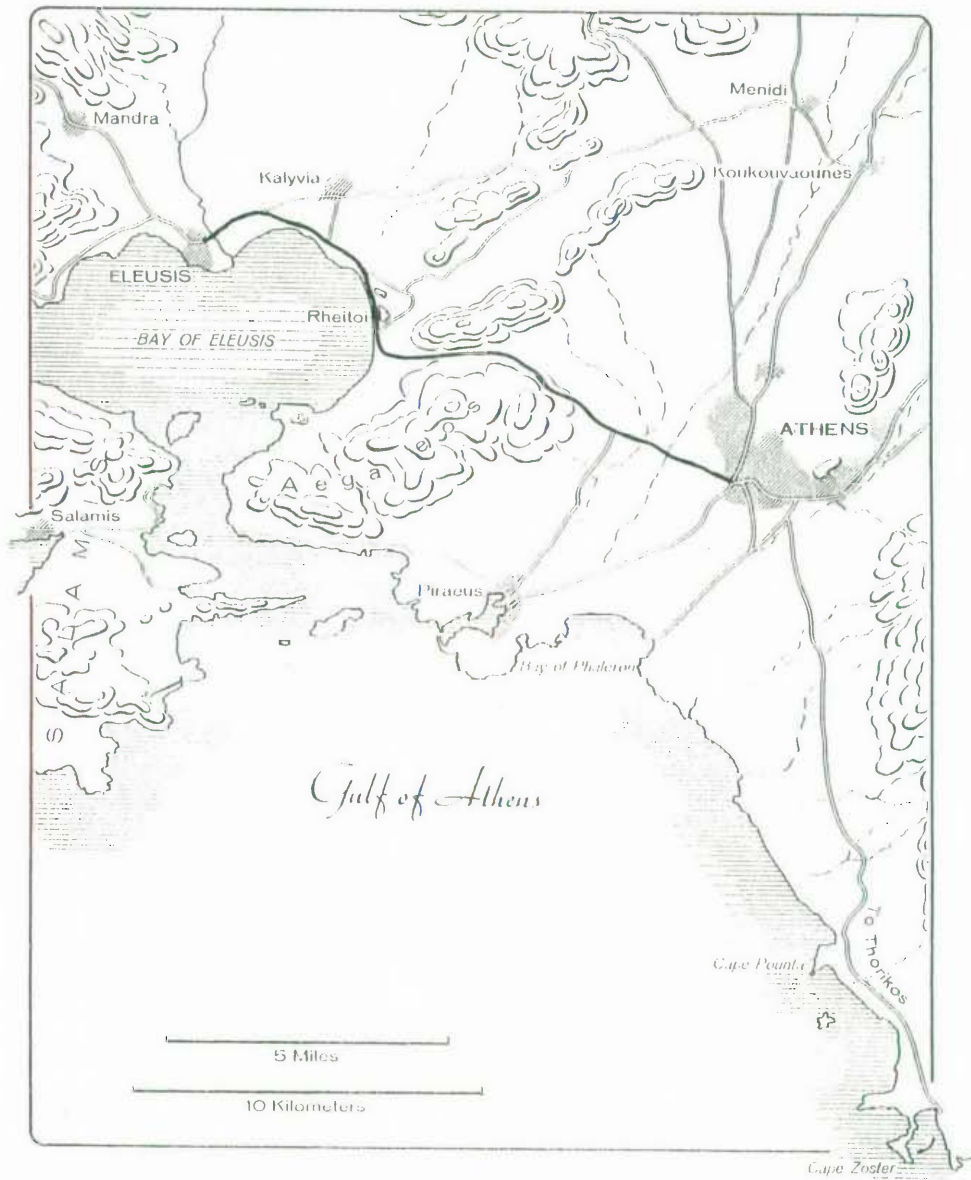
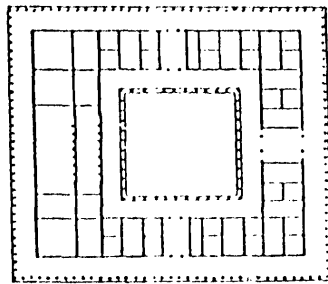
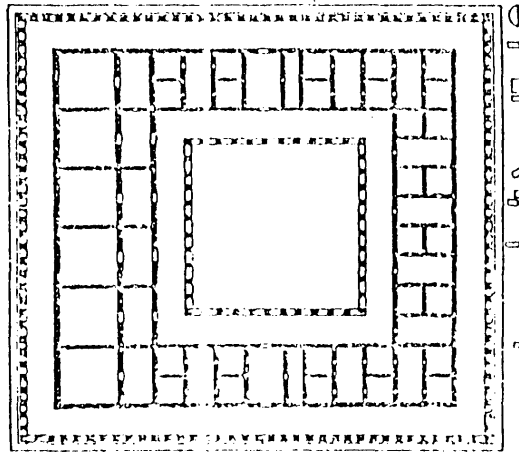


Figure 3.1: PLANS OF THE *KATAGOGION*, THE *LEONIDAION*, AT OLYMPIA.



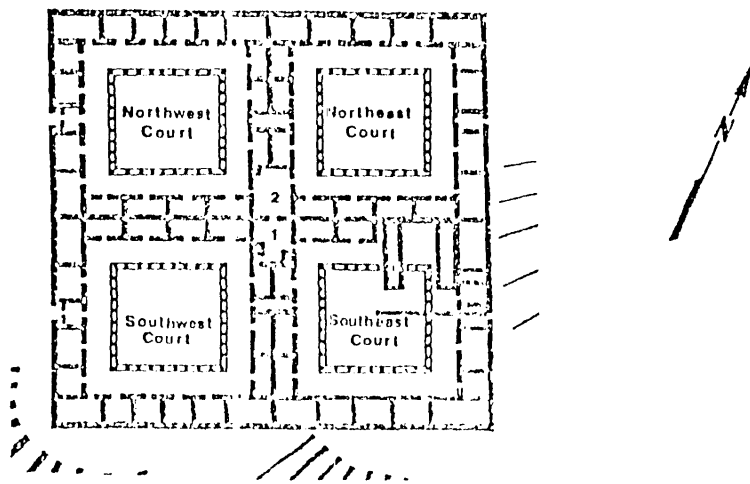
1. The Leonidaion - traditional plan



2. The Leonidaion - Mallwitz's plan

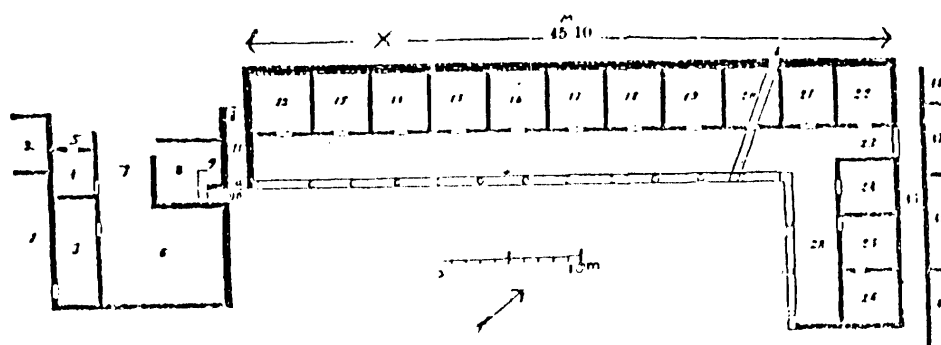


Figure 3.2: PLAN OF THE EPIDAUURIAN KATAGOGION.

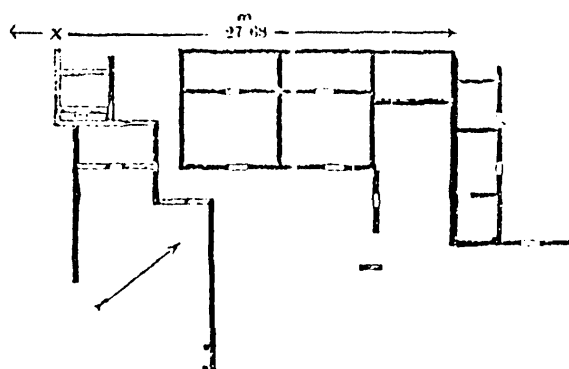


The katagogion

Figure 3.3: PLANS OF THE OROPAN KATAGOGIA.



1. Winter Katagogion (L-shaped stoa); portion of Summer Katagogion on left (rooms 1-11)



2. Summer Katagogion

Figure 4.1: FEMALE ATHLETE DRESSED AS FOR THE HERA RACES AT OLYMPIA.
Spartan bronze of the late sixth century.

